



EEx-Rotating Beacon dSLD 21

Modular concept with GRP housing for use in areas with explosive atmospheres in zone 1 and 2

- ▶ ATEX II 2 G EEx de IIC T6
- ▶ Housing made of glass-fibre reinforced polyester (GRP)
- ▶ Light intensity: Halogen H1, 20 W
- ▶ Protection: IP 66
- ▶ Safety class II
(no equipotential bonding necessary)
- ▶ Integrated terminal box realized in Ex protection mode increased safety

Application

Hazardous areas often require the use of optical signals for warning or information purposes. The EExII rotating beacon dSLD 21 offers both of these signalling features. It is designed for continuous operation. If the supply voltage is turned on, the rotating beacon dSLD 21 is activated.

The device is available in several versions with various levels of operating voltage and various signalling colours. The stable, glass-fibre reinforced polyester (GRP) housing is made to the IP66 degree of protection and may be used indoors or outdoors. The II 2 G EEx de IIC T6 protection class enables the unlimited use of the signalling device in all hazardous areas, zones 1 and 2.

Design

The flameproof enclosure and the "increased safety" type of protection of the terminal room guarantee hazardous area protection. The upper part of the flameproof enclosure, which contains the electronic and the mounted halogen lamp, consists of a transparent Makrolon-cap. An inner cap lends colour to the light.

The housing consists completely of GRP. Thus the device is protected against corrosion, and fulfills the requirements of contact safety class II. An equipotential bonding is not required. All outer fastening parts are manufactured in non corrosive materials.

Emergency indicator at Oil Production

Hazardous areas often require the use of optical signals for warning purposes.



Technical Datas

Housing-bottom part:	GRP glass-fibre reinforced polyester Colour: black
Housing-upper part	Makrolon (Polycarbonat), Colour: clear colour generated via coloured inner cap; colours: red, amber, green, blue; standard: amber installed, red enclosed
Protection:	IP 66 (IEC529)
Protection class:	II (no equipotential bonding necessary)
Cable gland:	1x M20 x 1.5 cable gland and 1 blind plug M20 x 1.5
Connection terminals:	1.5 mm ² fine wire 2.5 mm ² single wire
Operating conditions:	indoors and outdoors
Operating position:	Hanging or Standing The device may not be mounted horizontally
Light source:	Halogen H1, 20 W
Projection:	Triple lense system (Fresnel lense) approx. 60 r/min.
Operating mode	Continuous
Temperature range	
Operation	-20° C bis +40° C
Storage	-30° C bis +80° C
Explosion Protection	II 2 G EEx de IIC T6
Weight	ca. 3.5 kg

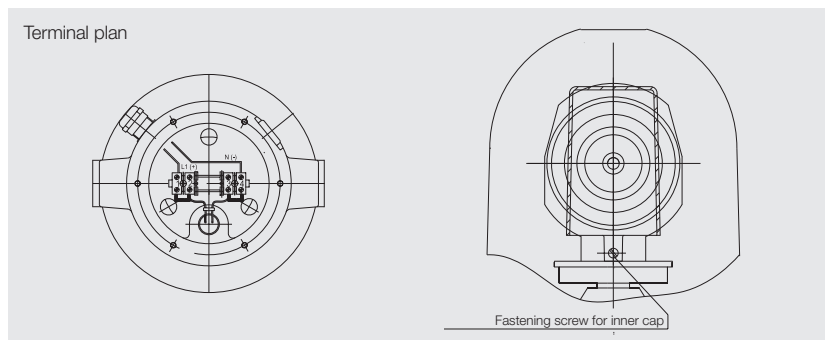
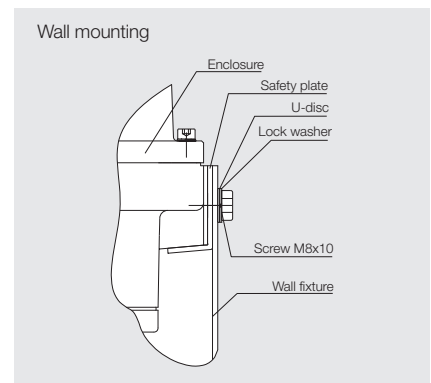
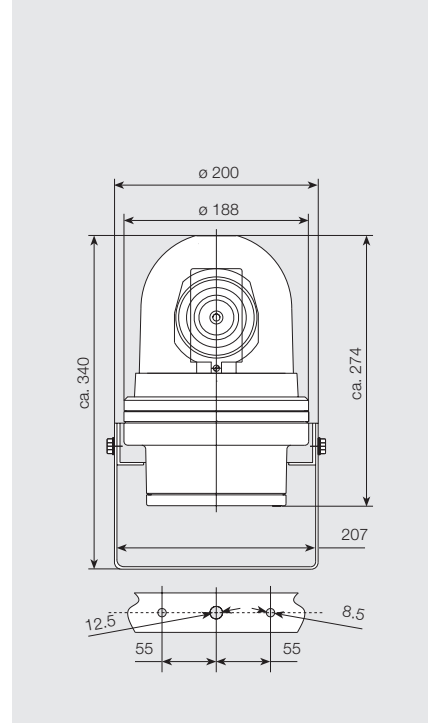

Order information

Type	Name	Rated Voltage U _e	Voltage range	Current Cons.	Article no.
dSLD 21	EEx II-Rotating Beacon	24 VAC/DC	+10/-15%	0.9 A	920 020 000 100 10
dSLD 21	EEx II-Rotating Beacon	230 VAC 50Hz	+10/-10%	0.1 A	920 020 000 200 10

other voltages on request